

# Integrated thermostatic valve set

Available versions:



The left or right-hand version determines the position of the thermostatic insert or manual valve with male thread.

Colour Options: ● ●



Angled valve - 90°

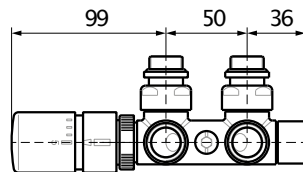
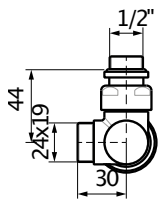

Inline valve

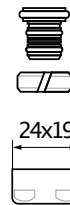
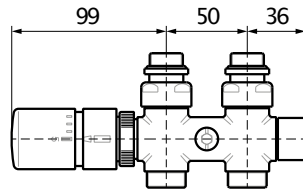
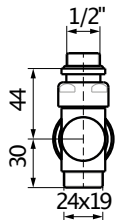

Adapter for ALU-PEX installaKon

Ø16x2

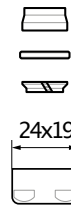

Adapter for copper installaKon

Ø15

Position	Size	Colour	Product code
<b>Angled valve - 90°</b>			
Left	GZ 1/2" - Ø16x2, Ø15	Chrome	WRZT5G1-CR
Right	GZ 1/2" - Ø16x2, Ø15	Chrome	WRZT5G2-CR
Left	GZ 1/2" - Ø16x2, Ø15	Satin	WRZT5G1-ST
Right	GZ 1/2" - Ø16x2, Ø15	Satin	WRZT5G2-ST
<b>Inline valve</b>			
Left	GZ 1/2" - Ø16x2, Ø15	Chrome	WRZT5G3-CR
Right	GZ 1/2" - Ø16x2, Ø15	Chrome	WRZT5G4-CR
Left	GZ 1/2" - Ø16x2, Ø15	Satin	WRZT5G3-ST
Right	GZ 1/2" - Ø16x2, Ø15	Satin	WRZT5G4-ST