

# Nouveau

Product Fact Sheet



**ex.t**

info@ex-t.com / ex-t.com

# Nouveau



**Design By**  
Bernhardt & Vella

**Code**  
EXLAV70DXNOU  
EXLAV70DXNOU/LP

**Category**  
Washbasins

**Module Dimensions**  
70 x 37 x h 12 cm

**Materials**  
LivingTec®

**Colours**

- White - RAL 9016
- Light Pink NCS S 2010 - Y50R

**Weight**  
Product 10 kg  
Packaging 2 kg

**Packaging Dimensions**  
81 x 51 x 22

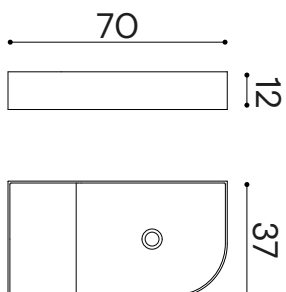

# Nouveau

Scala 1:10

